



10a New Street

ELSHAM, NORTH LINCOLNSHIRE, DN20 0RW



paul fox  
FINEST





# 10a New Street

Elsham, North Lincolnshire, DN20 0RW

A fine traditional detached family home surrounded by private enclosed grounds with beautifully presented accommodation that has had a recent and extensive refurbishment.

The accommodation comprises, central reception hallway, cloakroom, fine front living room, stylish fitted breakfasting kitchen, pleasant sitting room with an open aspect to a side conservatory, large rear sitting room with access to the garden.

The remodelled first floor enjoys a central landing leading to a luxury family bathroom and 4 double bedrooms with a master en-suite shower room.

Gated access to the front leads onto a substantial pebbled driveway allowing extensive parking for a large number of vehicles with direct access to the garaging.

Surrounding gardens come laid to lawn with a number of private seating areas.

Viewing of this superb home comes with the agents highest of recommendations.





### Reception Hallway

Measures approx. 2.1m x 6.2m (6' 11" x 20' 4"). Front composite front panelled entrance door with adjoining frosted glazed side lights, attractive quality laminate flooring, modern enamel radiator, return staircase leads to the first floor accommodation with spun balustrading and squared newel post, wall mounted Hive thermostatic control for the central heating and wall to ceiling coving.

### Fine Main Living Room

Measures approx. 5.49m x 4.37m (18' x 14' 4"). Front uPVC double glazed window, handsome recessed fire with brick backing, granite style hearth with TV mount above, wall to ceiling coving and ceiling rose.

### Pleasant Sitting Room

Measures approx. 2.74m x 3.23m (9' x 10' 7"). Front uPVC double glazed window, continuation of matching flooring from the entrance hallway, inset ceiling spotlights and a broad opening leads through to;

### Conservatory

Measures approx. 3.1m x 3.25m (10' 2" x 10' 8"). With dwarf walling, surrounding uPVC double glazed windows, rear French doors leading out to the garden, continuation of matching flooring from the sitting room and plastered ceiling with inset ceiling spotlights.





### Inner Hallway

Has understairs storage cupboard and access through to the sitting room and to the cloakroom.

### Rear Sitting Room

Measures approx. 3.33m x 4.62m (10' 11" x 15' 2"). Rear picture uPVC window, matching side French doors leading to the garden, attractive laminate flooring, ceramic modern radiator, built-in storage cupboard, wall to ceiling coving and TV point.

### Cloakroom

Measures approx. 1.55m x 2.08m (5' 1" x 6' 10"). Side uPVC double glazed window with frosted glazing providing a quality suite in white comprising close couple low flush WC, adjoining vanity units with above moulded sink, tiled splash back, tiled flooring and inset ceiling spotlights.

### Stylish Fitted Breakfasting Kitchen

Measures approx. 5.46m x 3.43m (17' 11" x 11' 3"). Rear uPVC entrance door allowing access to the garden and broad rear uPVC double glazed window. The kitchen enjoys an extensive range of contemporary gloss finished furniture with curved pull handles with a complementary patterned top with matching uprising incorporating a one and a half bowl stainless steel sink unit with drainer to the side and block mixer tap, built-in five ring electric hob with overhead glazed and stainless steel extractor, eye level double oven, plumbing and space for an automatic washing machine, dryer, dishwasher and American style fridge freezer, central breakfasting island incorporating an integral fridge, tiled flooring and inset ceiling spotlights.





### First Floor Central Landing

Measures approx. 2.16m x 3.5m (7' 1" x 11' 6"). Rear uPVC double glazed half landing window, continuation of balustrading, wall to ceiling coving, loft access with drop down ladder and built-in corner fitted airing cupboard with shelving.

### Rear Double Bedroom 1

Measures approx. 4.14m x 3.45m (13' 7" x 11' 4"). With a broad rear uPVC double glazed window enjoying attractive views across the garden, wall to ceiling coving, inset ceiling spotlights and oak door through to;

### En-Suite Shower Room

Measures approx. 1.2m x 3.45m (3' 11" x 11' 4"). Side uPVC double glazed window with frosted glazing providing a modern suite in white comprising a low flush WC, matching vanity wash hand basin, walk-in shower with overhead main shower, rainwater head and glazed screen, tiled flooring, fully tiled walls with chrome edging and matching towel rail and inset ceiling spotlights.

### Front Double Bedroom 2

Measures approx. 2.64m x 4.37m (8' 8" x 14' 4"). Front uPVC double glazed window, wall to ceiling coving and inset ceiling spotlights.

### Front Double Bedroom 3

Measures approx. 2.72m x 3.33m (8' 11" x 10' 11"). Front uPVC double glazed window, wall to ceiling coving and inset ceiling spotlights.



### Front Double Bedroom 4

Measures approx. 3.3m x 2.84m (10' 10" x 9' 4"). Front uPVC double glazed window, wall to ceiling coving and inset ceiling spotlights.

### Luxury Family Bathroom

Measures approx. 2.77m x 2.51m (9' 1" x 8' 3"). Rear uPVC double glazed window with frosted glazing providing a style suite in white comprising a free standing bath with floor mounted chrome mixer tap, close couple low flush WC with adjoining vanity unit with above wash hand basin, walk-in shower with overhead main shower and rainwater with glazed screen, tiled flooring, fully tiled walls with chrome edging, fitted chrome towel rail and inset ceiling spotlights.

### Outbuildings

The property benefits from an original brick outbuilding with oak frame having an open fronted double garage measuring 5.2m x 7.5m (24' 5" x 17' 1") with attractive stone flagged flooring, internal power and lighting, pitched roof providing storage.

Adjoining is a closed garage measuring 5.05m x 5.2m (16' 7" x 17' 1") with double opening oak doors adjoining window, flagged flooring, plastered and boarded ceiling and inset ceiling spotlights.

Within the garden there is a timber summer house.







### Grounds

The property enjoys a central village location and enjoys a substantial plot enclosed with mature hedged and fenced boundaries providing excellent security and screening with vehicular entry via double opening timber gates between brick pillars with coping tops onto a large pebbled driveway that allows parking for an excellent number of vehicles and access to the garaging. The gardens which surrounds the property come principally lawned with Indian slate flagged and block edged pathway leading to the front entrance door and around to the rear creating a very private seating area. To the rear there is gated access.

### Double Glazing

Full uPVC double glazed windows and doors with the exception of the front door being composite.

### Central Heating

There is a modern gas fired central heating system to radiators.





## FLOORPLAN AND EPC

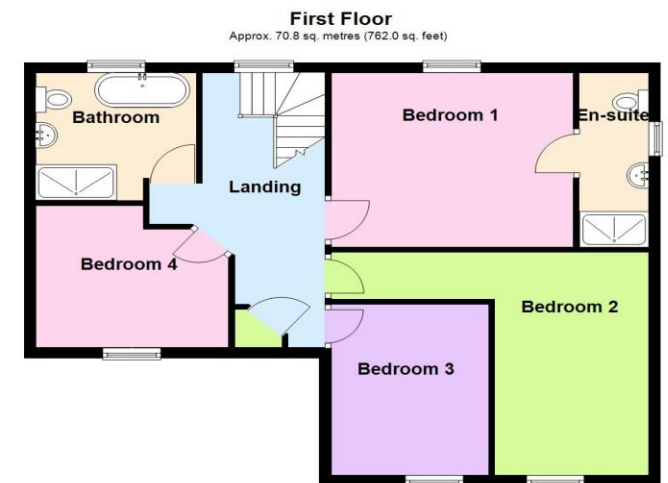
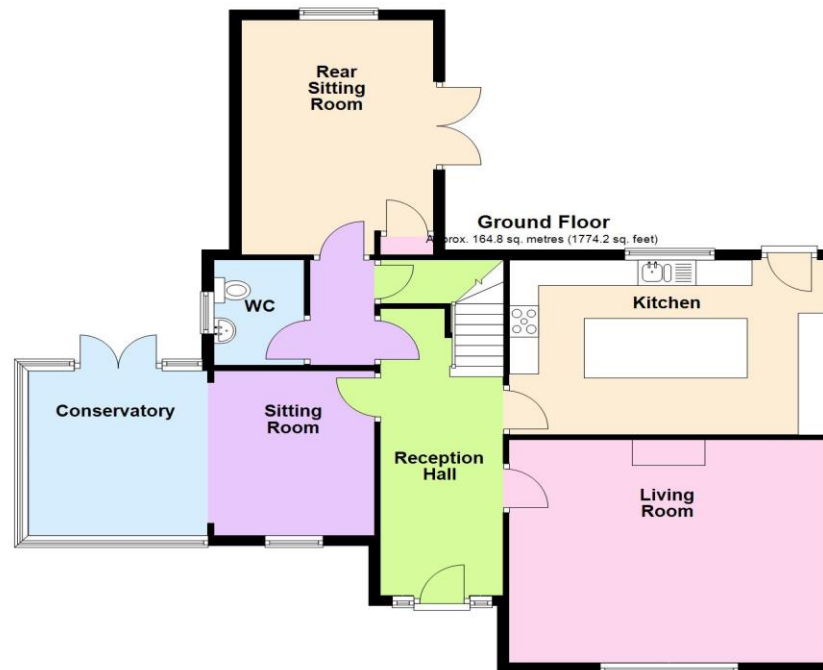
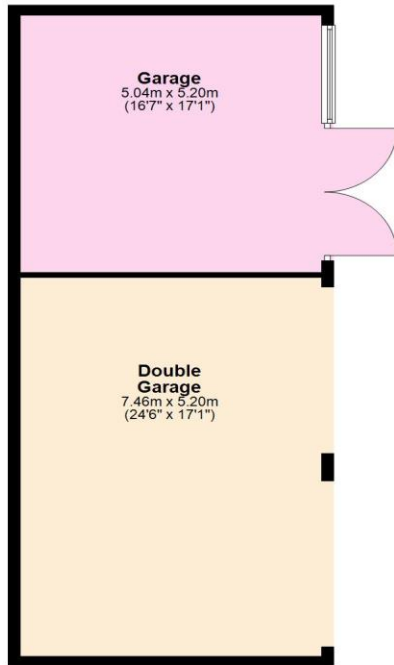









[www.paul-fox.com](http://www.paul-fox.com)

**CONSUMER PROTECTION FROM UNFAIR TRADING REGULATIONS 2008 (CRPS):** Paul Fox on their behalf and for the sellers of this property whose agents they are give notice that (i) these particulars are intended to be a general outline only for the guidance of the prospective purchasers and do not constitute part of any contract (ii) all descriptions, dimensions, references to condition and necessary permissions for use and occupation and any other details are given in good faith and are believed to be correct and have been approved by the vendor, however intending purchasers should not rely on them. (iii) no persons employment by Paul Fox has any authority to make or give representation or warranty in relation to this property and no electrical or gas appliances whether included or to be sold as additional items by the vendor have been tested by the vendor or their agents. (iv) nothing in these particulars, including photographs, intend to imply that any carpets or curtains, furniture or fittings, electrical or gas appliances whether or not wired or plumbed in, or any fixtures not expressly included as part of the property are offered for sale. Certain items may be purchase under separate negotiation.

In accordance with Consumer Protection from Unfair Trading regulations 2008 (CPRS) Paul Fox endeavors and makes every effort to ensure that any information provided to prospective purchase is fair and as accurate to the best of their knowledge and is not in any way believed to be misleading. Consumers are protected under this legislation from misleading statements. The office of Fair Trading has published guidance documents for Consumers Selling or buying Property and these are available from Paul Fox upon request. These particulars are intended to give a fair and substantially correct overall description for the guidance of intending purchasers. No reasonability is to be assumed for the occupancy of individual items and no appliances or services have been tested by the Agent. P389

**VIEWING STRICTLY  
BY APPOINTMENT**

**T: 01652 651777**  
**E: [finest@paul-fox.com](mailto:finest@paul-fox.com)**

**10 Market Place,  
Brigg, DN20 8ES**